



MTV-FS1 / FS1T / FSB375

MYE Entertainment Freestanding LCD TV Floor Stand with Base

Assembly Instructions



Table of Contents

Parts List.....	3
Parts Identification.....	3
Hardware List.....	5
Stand Assembly.....	5
Limited Warranty.....	8

Overview:

The MTV-FS Floor Stand is designed to support the MYE Entertainment MTV15 LCD. It offers sturdy free standing support while allowing optimal access and viewing angle.

Parts List

MTV-FS1-S	MYE LCD TV Floor Stand Upright	
FSVTL	1	Floor Stand Vertical Tube Lower
FSVTU	1	Floor Stand Vertical Tube Upper
FSHBA	1	Floor Stand Hinge Bracket Assembly
FSTHW-L	1	Floor Stand Horizontal Tube (Weldment)
MTV-FSB305	MYE LCD TV Floor Stand BASE 30.5"	
FSB305W	1	Base Weldment 30.5"
FSBF	2	Floor Stand Base Foot
FSBPSB	1	Floor Stand Power Supply Bracket
FSBCCE305	2	Base Cable Chase Extrusion 11.25"
FSBCCC305	2	Base Cable Chase Cover 11.25"
FSBEC	2	Base End Cap
FSBC	1	Floor Stand Base Cover Assembly
		Base Cover - Front
		Base Cover - Rear

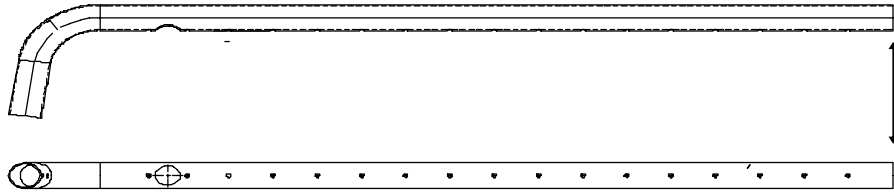

FSVTU
FSVTUL

Vertical Tube Upper (Vertical Tube Upper – Long)



FSVTL

Vertical Tube Lower

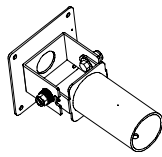

FSHBA

HINGE BRACKET
ASSEMBLY



FSCHP

CABLE HOLE
PLUG

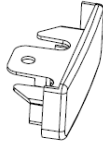

FSBEC

BASE END
CAP

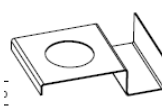

FSBPSB

POWER SUPPLY
BRACKET

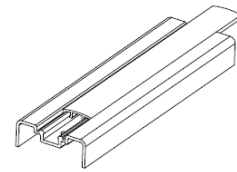

FSBCCC305
FSBCCE305

CABLE CHASE COVER
CABLE CHASE EXTRUSION

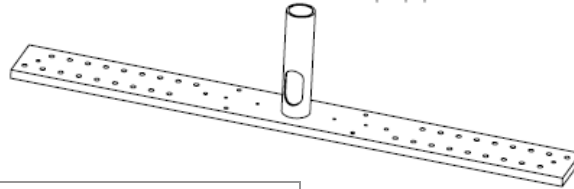

FSB305W
FSB375W

Floor Stand Base Weldment

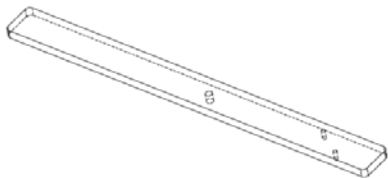

FSBF

BASE FOOT

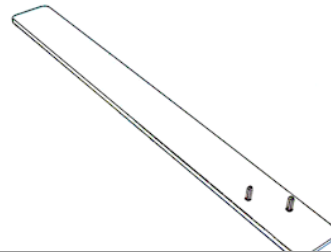

FSBF-375B

BASE FOOT (FLAT)

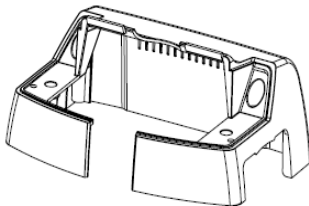

FSBC2

Base Cover - Rear



FSBC2

Base Cover - Front

Hardware List

BASE ASSEMBLY HARDWARE		PLACEMENT DESCRIPTION
4	1/4-20 x 7/8" Socket Head Cap Screw	Feet to Base Weldment
4	1/4-20 x 5/8" Phillips Head Screw	Base End Cap / Base Cover Extrusion
2	1/4-20 x 2-1/2 Socket Head Cap Screw	Base Cover Front to Base Weldment
2	1/4-20 x 1-3/8" Socket head Cap Screw	Base Cover Rear to Base Weldment
2	#8-32 x 7/16 Phillips Head Self Tapping	Base Cover Front to Base Cover Rear
4	1/4 -20 X .25 Kep Locking Nut	Treadmill Flat Feet to Bade Weldment (FS375B FEET)
UPPER STAND ASSEMBLY HARDWARE		PLACEMENT DESCRIPTION
2	1/4-20 x 1/4" Socket Head Cap Screw	Lower Vertical Tube to Base Weldment
2	1/4-20 x 1/4" Socket Head Cap Screw	Lower Vertical Tube to Upper Vertical
2	1/4-20 x 1/4" Socket Head Cap Screw	Upper Vertical Tube to Upper Horizontal (Optional)
2	1/4-20 x 1/4" Socket Head Cap Screw	Upper Vertical Tube to Hinge Bracket Assembly

STAND ASSEMBLY

STEP 1

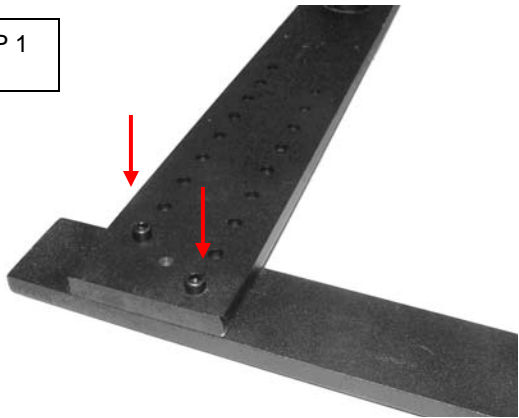

Determine the width of the 2 stand feet in relation to the cardio equipment it is to be placed in front of. Use the 1/4x20 socket head screws to secure the Feet to the stand Base Weldment.

STEP 2

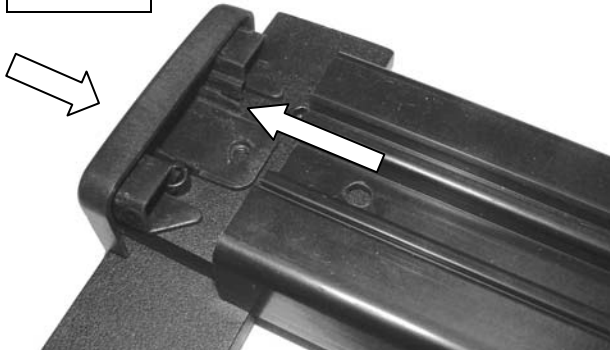

Install the Base End Cap and then slide the Cable Chase Extrusion into place on the Base Weldment.

STEP 1- B*

FSBF375B TREADMILL FEET ONLY

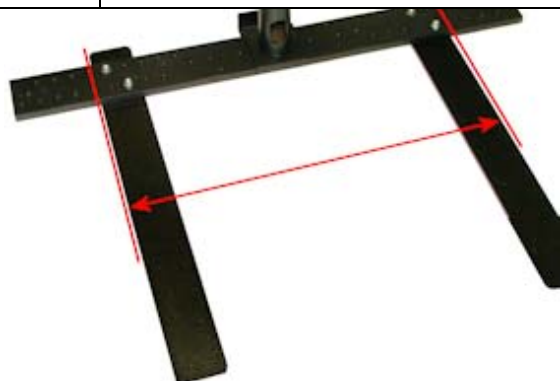

For TREADMILLS: Determine the distance needed between the flat stand feet in order to safely slide the stand under the front of the treadmill.

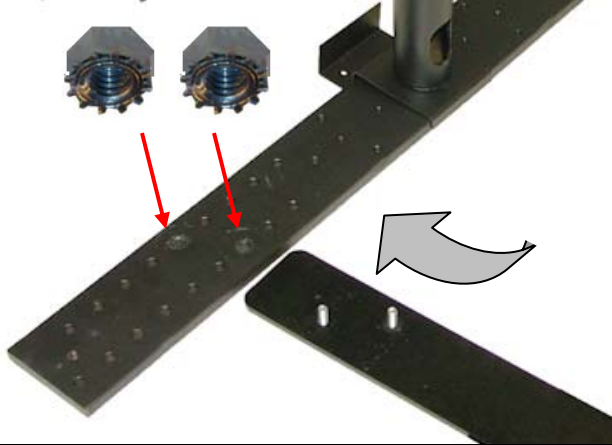

For TREADMILLS (cont.) Attach the flat stand feet through the bottom of the Base holes using the 1/4x20 Kep Locking Nuts

STEP 3



After sliding the Base Cable Chase Extrusion into the Base End cap, attach it to the Base Weldment using the (2) 1/4x20 socket head screws

STEP 4

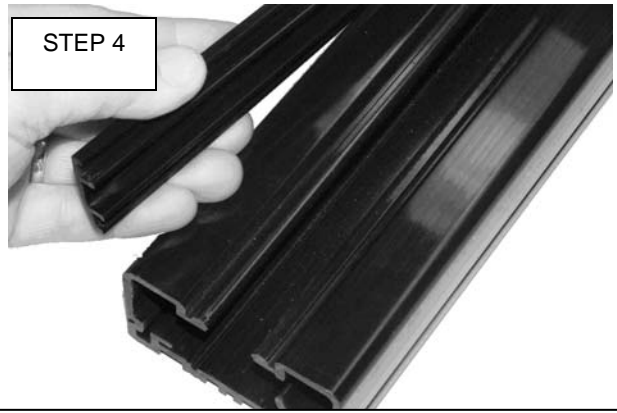

Snap the Cable Chase Cover into place on the Base Cable Chase Extrusion.

STEP 5

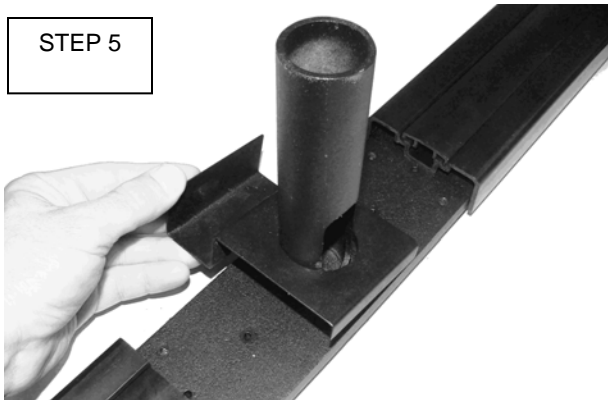

Place the Power Supply Bracket into place over the base weldment tube.

STEP 6

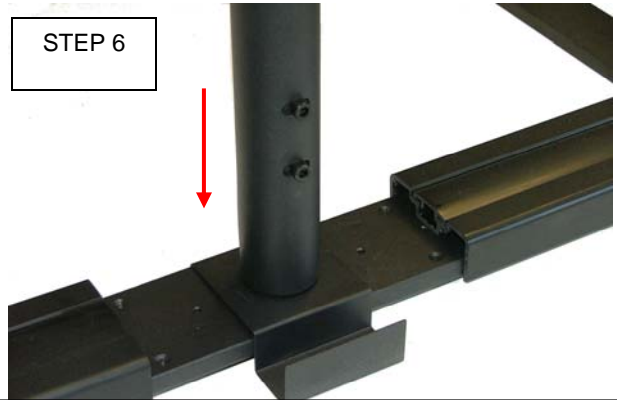

Insert the Vertical Tube Lower on the base tube weldment and align the cable access holes. Install the 1/4-20 Socket Head Cap Screws and adjust to the necessary rotation.

STEP 7

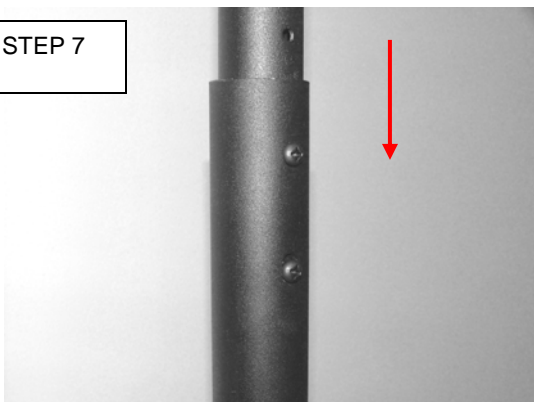

Insert the Vertical Tube Upper into the lower tube. Align the holes in each to tube at the desired screen height. Secure using the Socket Head Cap Screws.

STEP 8

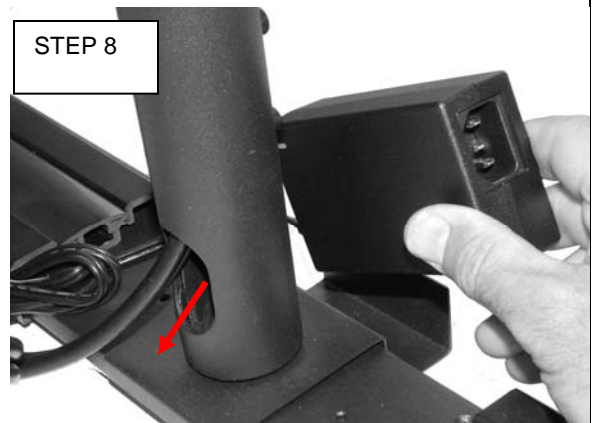

With the Upper and Lower Vertical Tubes installed run the low voltage power and RG6 coaxial cable through the stand and out the lower vertical cable access hole. Place the power supply in the Power Supply Bracket.

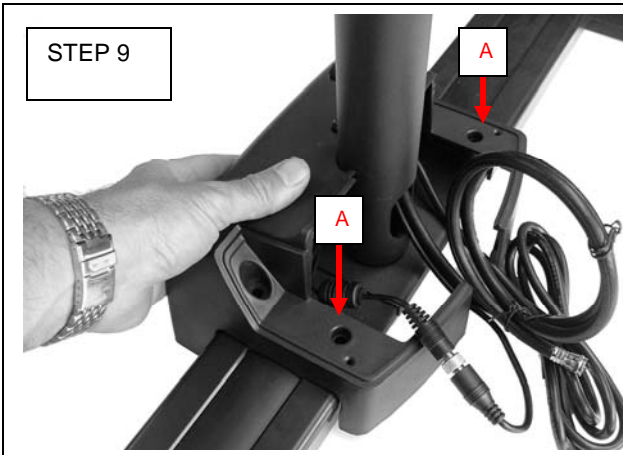

Connect power supply and coaxial cords. Place Base Cover Rear onto Cable Chase and run all cables through front access hole. Secure the Base Cover Rear to Base Weldment through holes A.

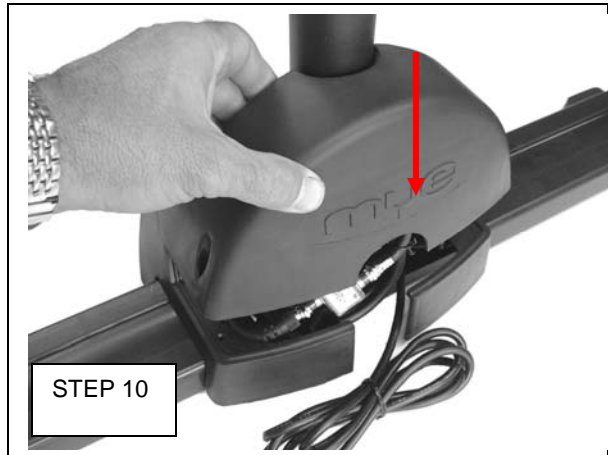

Mate the Base Cover Front onto Base Cover Rear routing all cables through the cable access hole.

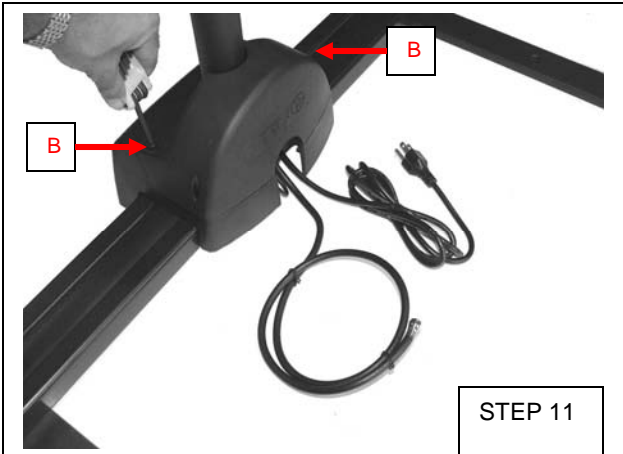

Secure the Base Cover Front to Stand Base Weldment through holes B. Run the RG6 coax cable and the 110 AC power cord out the Base Cover wire hole. Attach with .25x20 socket head screws.

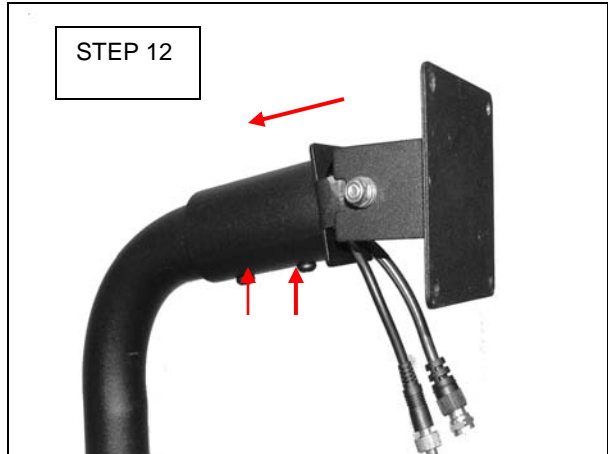

Attach the Hinge Bracket Assembly to the Stand Vertical Upper Tube and run the Dual Cable RG6 and 110 AC cable out the end. Secure by using Socket Cap Head Screws.

WARRANTY

PLEASE READ THESE WARRANTY TERMS AND CONDITIONS CAREFULLY BEFORE USING YOUR MYE ENTERTAINMENT PRODUCT. BY USING THE EQUIPMENT, YOU ARE CONSENTING TO BE BOUND BY THE FOLLOWING WARRANTY TERMS AND CONDITIONS.

LIMITED WARRANTY

MYE ENTERTAINMENT (MYE) WARRANTS ALL NEW MYE PRODUCTS TO BE FREE FROM DEFECTS IN MATERIALS AND MANUFACTURERS FOR THE WARRANTY PERIODS SET FORTH BELOW. THE WARRANTY PERIODS COMMENCE ON THE INVOICE DATE OF THE ORIGINAL PURCHASE. THIS WARRANTY APPLIES ONLY AGAINST DEFECTS DISCOVERED WITHIN THE WARRANTY PERIOD AND EXTENDS ONLY TO THE ORIGINAL PURCHASER OF THE PRODUCT. PARTS REPAIRED OR REPLACED UNDER THE TERMS OF THIS WARRANTY WILL BE WARRANTED FOR THE REMAINDER OF THE ORIGINAL WARRANTY PERIOD ONLY. TO CLAIM UNDER THIS WARRANTY, THE BUYER MUST NOTIFY MYE OR YOUR AUTHORIZED MYE ENTERTAINMENT DEALER WITHIN 30 DAYS AFTER THE DATE OF DISCOVERY OF ANY NONCONFORMITY AND MAKE THE AFFECTED PRODUCT AVAILABLE FOR INSPECTION BY MYE ENTERTAINMENT OR ITS SERVICE REPRESENTATIVE. MYE ENTERTAINMENT PRODUCTS DEEMED DEFECTIVE BY A MYE ENTERTAINMENT REPRESENTATIVE WILL BE ISSUED A RETURN AUTHORIZATION NUMBER. MYE ENTERTAINMENT WILL NOT ACCEPT RETURNS WITHOUT A RETURN AUTHORIZATION NUMBER. MYE ENTERTAINMENT RESERVES THE RIGHT, AT THEIR OPTION, TO REPAIR OR REPLACE THE PRODUCT AFTER VERIFICATION OF DEFECT. PRODUCT THAT FAILS AFTER THE WARRANTY PERIOD EXPIRES WILL BE REPAIRED OR REPLACED AT THE CURRENT PART AND LABOR PRICING AFTER AUTHORIZATION FROM THE CUSTOMER. REPAIRS ARE WARRANTED FOR 90 DAYS. MYE ENTERTAINMENT'S OBLIGATIONS UNDER THIS WARRANTY ARE LIMITED AS SET FORTH BELOW:

WARRANTY PERIODS AND COVERAGE:

MTV-FS1	1 YEAR
MTV-FS1T	
MTV-FSB375	

CONDITIONS AND RESTRICTIONS:

THIS WARRANTY IS VALID ONLY IN ACCORDANCE WITH THE FOLLOWING CONDITIONS:

THE WARRANTY APPLIES TO THE MYE ENTERTAINMENT PRODUCT ONLY 1) WHILE IT REMAINS IN THE POSSESSION OF THE ORIGINAL PURCHASER AND PROOF OF PURCHASE IS DEMONSTRATED. 2) IT HAS NOT BEEN SUBJECT TO ACCIDENT, MISUSE, ABUSE, IMPROPER SERVICE, MECHANICAL OR ELECTRICAL NON-MYE ENTERTAINMENT AUTHORIZED MODIFICATION. 3) CLAIMS MADE WITHIN THE WARRANTY PERIOD. THIS WARRANTY DOES NOT COVER DAMAGED OR FAILURE CAUSED BY ELECTRICAL WIRING NOT BEING IN COMPLIANCE WITH ELECTRICAL CODES OR MYE'S OWNER MANUAL SPECIFICATIONS, OR FAILURES TO PROVIDE REASONABLE AND NECESSARY MAINTENANCE AS OUTLINED IN THE OWNER'S MANUAL.

WARRANTIES OUTSIDE THE UNITED STATES AND CANADA MAY VARY. PLEASE CONTACT YOUR LOCAL DEALER FOR DETAILS.

LIMITED WARRANTY SHALL NOT APPLY TO:

- 1) SOFTWARE UPGRADES.
- 2) NORMAL WEAR AND TEAR, CONSUMABLES AND COSMETIC ITEMS INCLUDING BUT NOT LIMITED TO LABELS.
- 3) REPAIRS REFORMED ON MYE PRODUCTS MISSING A SERIAL NUMBER OR WITH A SERIAL TAG THAT HAS BEEN ALTERED, REATTACHED OR DEFACED.
- 4) SERVICE CALLS TO CORRECT INSTALLATION OF THE PRODUCT OR INSTRUCT OWNERS ON HOW TO USE THE PRODUCT.
- 5) PICK UP AND DELIVERY INVOLVING REPAIRS
- 6) ANY LABOR COSTS INCURRED BEYOND THE APPLICABLE LABOR WARRANTY PERIOD
- 7) THE USER IS CAUTIONED THAT CHANGES OR MODIFICATIONS NOT EXPRESSLY APPROVED BY THE MANUFACTURER OF THE PRODUCT COULD VOID THE USER'S AUTHORITY TO OPERATE THE PRODUCT.

WARRANTY – cont.

THE WARRANTIES PROVIDED HEREIN ARE THE EXCLUSIVE WARRANTIES GIVEN BY MYE ENTERTAINMENT AND SUPERSEDE ANY PRIOR, CONTRARY OR ADDITIONAL REPRESENTATIONS, WHETHER ORAL OR WRITTEN. ANY IMPLIED WARRANTIES, INCLUDING THE WARRANTY OF MERCHANTABILITY OR FITNESS FOR A PARTICULAR PURPOSE THAT APPLY TO ANY PARTS DESCRIBED ABOVE ARE LIMITED IN DURATION TO THE PERIODS OF EXPRESS WARRANTIES GIVEN ABOVE FOR THOSE SAME PARTS. MYE HEREBY DISCLAIMS AND EXCLUDES THOSE WARRANTIES THEREAFTER. SOME STATES DO NOT ALLOW LIMITATIONS ON HOW LONG AN IMPLIED WARRANTY LASTS, SO THE ABOVE LIMITATION MAY NOT APPLY TO YOU. MYE ENTERTAINMENT ALSO HEREBY DISCLAIMS AND EXCLUDES ALL OTHER OBLIGATIONS OR LIABILITIES, EXPRESS OR IMPLIED, ARISING BY LAW OR OTHERWISE, WITH RESPECT TO ANY NONCONFORMANCE OR DEFECT IN ANY PRODUCT, INCLUDING BUT NOT LIMITED TO: (A) ANY OBLIGATION, LIABILITY, RIGHT, CLAIM OR REMEDY IN TORT, WHETHER OR NOT ARISING FROM THE NEGLIGENCE OF MYE OR ITS SUPPLIERS (WHETHER ACTIVE, PASSIVE OR IMPUTED); AND (B) ANY OBLIGATION, LIABILITY, RIGHT, CLAIM OR REMEDY FOR LOSS OF OR DAMAGE TO ANY PRODUCT. THIS DISCLAIMER AND RELEASE SHALL APPLY EVEN IF THE EXPRESSED WARRANTY SET FORTH ABOVE FAILS OF ITS ESSENTIAL PURPOSE.

FOR ANY PRODUCT DESCRIBED ABOVE THAT FAILS TO CONFORM TO ITS WARRANTY, MYE ENTERTAINMENT WILL PROVIDE, AT THEIR OPTION ONE OF THE FOLLOWING: 1) REPAIR, 2) REPLACEMENT OR 3) REFUND OF THE PURCHASE PRICE.

MYE AND/OR ITS SUPPLIERS SHALL HAVE NO OBLIGATION OR LIABILITY, WHETHER ARISING IN CONTRACT (INCLUDING WARRANTY), TORT (INCLUDING ACTIVE, PASSIVE, OR IMPUTED NEGLIGENCE AND STRICT LIABILITY), OR OTHERWISE, FOR DAMAGE TO THE PRODUCT, PROPERTY DAMAGE, LOSS OF USE, REVENUE OR PROFIT, COST OF CAPITAL, COST OF SUBSTITUTE PRODUCT, ADDITIONAL COSTS INCURRED BY BUYER (BY WAY OF CORRECTION OR OTHERWISE) OR ANY OTHER INCIDENTAL, SPECIAL, INDIRECT, OR CONSEQUENTIAL DAMAGES, WHETHER RESULTING FROM NON-DELIVERY OR FROM THE USE, MISUSE OR INABILITY TO USE THE PRODUCT. THIS EXCLUSION APPLIES EVEN IF THE ABOVE WARRANTY FAILS OF ITS ESSENTIAL PURPOSES AND REGARDLESS OF WHETHER SUCH DAMAGES ARE SOUGHT FOR BREACH OF WARRANTY, BREACH OF CONTRACT, NEGLIGENCE OR STRICT LIABILITY IN TORT OR UNDER ANY OTHER LEGAL THEORY.

SOME STATES DO NOT ALLOW THE EXCLUSION OR LIMITATION OF INCIDENTAL OR CONSEQUENTIAL DAMAGES SO THE ABOVE LIMITATION MAY NOT APPLY TO YOU.

THIS WARRANTY GIVES SPECIFIC LEGAL RIGHTS. YOU MAY ALSO HAVE OTHER RIGHTS WHICH VARY FROM STATE TO STATE.



MYE Entertainment, Inc
25129 The Old Road
Suite 305
Stevenson Ranch, Ca. 91381
1-661-964-0217

rev. 071511

www.myeclubtv.com